

LOCALITY PLAN
1: 20,000

Note: This text in red is not part of this survey plan and is added for clarity. The area marked "A" on this plan is the area referred to as "Area 1" in the Cornwall Park Endowment and Recreation Land Act 1982, and in the Amendment Bill.

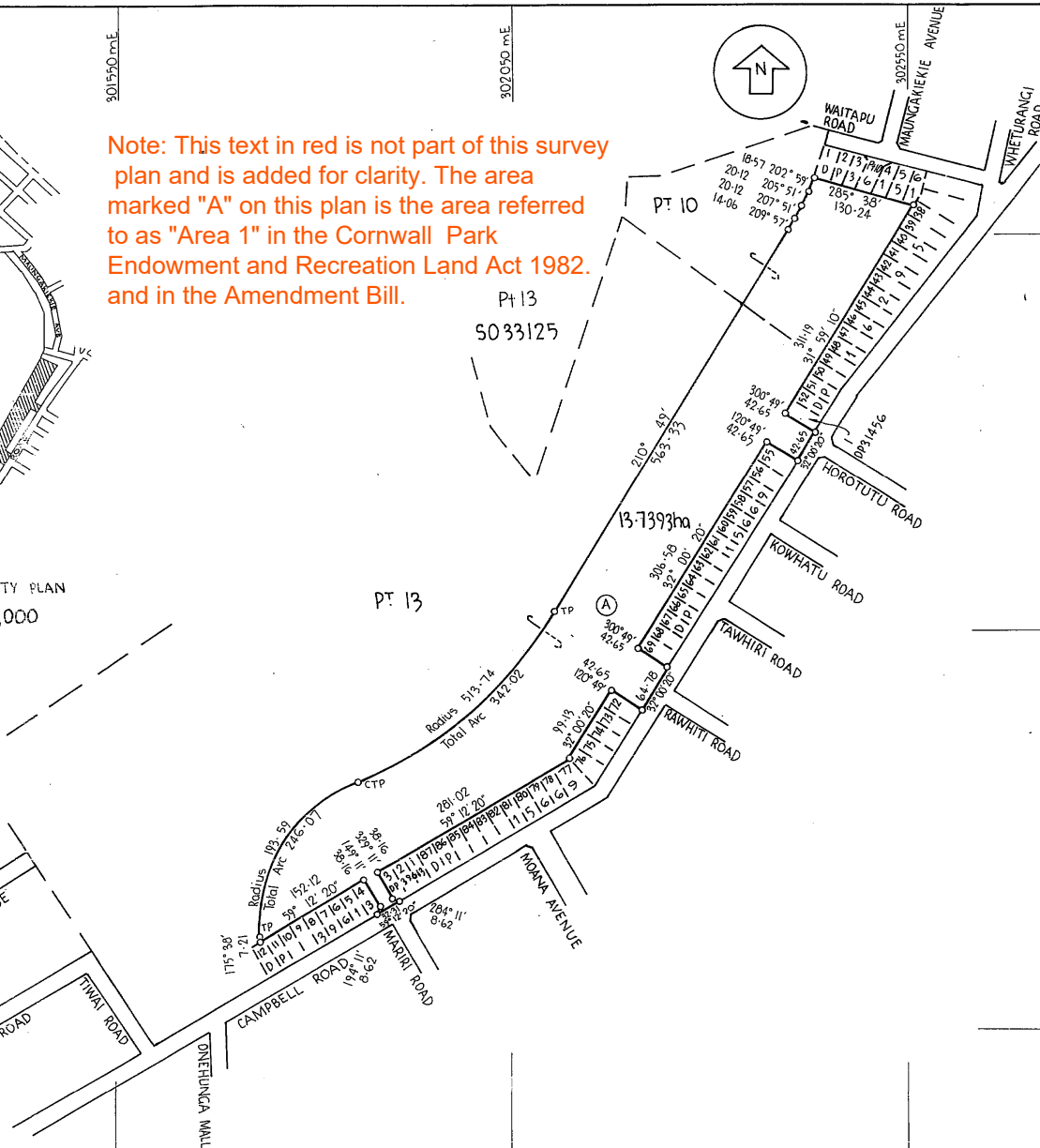

Approvals

Area Schedule
Description: Pt Allots 10 & 13, Section 12, Suburbs of Auckland
Title: CT 1012/215 Pt.
Shown: A Area: 13.7393 ha

Total Area 13.7393 ha
Comprised in PT CT 1012/215

I, Donald James Ruegg at Auckland
Registered Surveyor and holder of an annual practicing certificate hereby certify that this plan has been made from Surveys executed by me or under my direction; that both plan and Survey are correct and have been made in accordance with the regulations under the Surveyors Act 1966
Dated at AUCKLAND this 29th day of AUGUST 1980 Signature *[Signature]*

Field Book ... p. Traverse Book ... p.
Reference Plans D.P.'s 16295, 39613, 36151, 31456, 15669, LT 60707, 5033125
Examined Blair Correct Kemper

Approved for Parliamentary Purposes Only
39 9 / 80 Assistant Chief Surveyor *[Signature]*
Deposited this day of 19
District Land Registrar

File 14/10 Received SEP 10 1980 Instructions SO 55018

LAND DISTRICT **NORTH AUCKLAND**
SURVEY BLK. & DIST. 1 Otahuhu
NZMS SHEET No.

Cornwall Park Endowment and Recreation Land Bill 1980

LOCAL AUTHORITY One Tree Hill Borough
Surveyed by **HARRISON AND GRIERSON AND PARTNERS**
Scale 1: 4000 Date August 1980